

Yoswit Smart Home Gateway Datasheet

Model: YO105 (R2W)

Revised: 01-12-2024



Your Central Hub for Seamless Smart Home Integration and Control

Yoswit Smart Home Gateway is the nucleus of your smart home, seamlessly integrating Bluetooth and Wi-Fi communication protocols. Serving as the central hub for your smart devices, it facilitates effortless communication and coordination among them. You can remotely manage and monitor the gateway and connected devices through our Yoswit App, keeping you updated on their real-time status, whether online or offline. It offers compatibility with various third-party smart home systems, expanding your smart home ecosystem endlessly and enhancing the flexibility and convenience of your setup. Benefit from the ease of OTA remote upgrades and without any complex operations, your devices can automatically receive and install updates.

Key Features and Benefits

- Central Hub for Smart Devices
- Bluetooth Mesh & Wifi Enhance Connectivity and Extend Range
- Real-time Status Updates for Devices via Yoswit App
- Reliable Management of Multiple Devices
- Scenario and Automation Settings for Smart Devices
- Third-party Smart Home Systems Compatibility
- OTA Remote Upgrades



Various Customized Products

We offer a comprehensive selection of smart home products that are seamlessly adapted to the usage standards and various socket types in different countries, ensuring a smooth installation process for all users. With extensive compatibility, our products enable you to control a diverse range of household appliances, including lighting, air conditioning, and TV.



Light Switch



Dimmer Switch



2 Way Switch



Double Pole Switch



Gate Controlled Switch



Hidden Controlled Switch



Outlet



Roller



Curtain



Remote Control



Thermostat

Yoswit App

You can download our app to implement the following functions via Bluetooth and WiFi to control the Yoswit switches.

Time Setting

Scene Mode

Device Network

Away Detection

Password Protection

Network Control

Apple Siri

Google Assistant

IFTTT

Depends on Yoswit Bridge Solutions.



Product Specifications

Color Options: *You can also customize the colors



White



Black



Space Grey

Specifications:

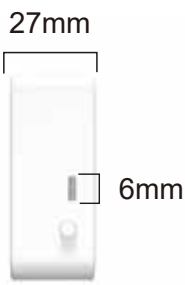

Electrical	
Operation Power	5V / 1A (DC)
Power Consumption	<0.1W
Wireless	
Frequency	2.4GHz
Connection	BLE 4.2
Range	Open Area: >50m / Interior: 3-20m

General Specifications

Product Name	Yoswit Smart Home Gateway
Model	YO105 (R2W)
EAN / UPC	EAN: 0765756498326 / UPC: 765756498326
Revision	V7.0
Compliance	ETL, CE, FCC, RoHS
Manufacturer	Designed by Yoswit in Hong Kong, China / Assembled in Guangdong, China
Warranty	Two Year Limited Warranty (*Details available on the Product Warranty and Limitations of this datasheet)

Mechanical

Operating Temperature	-10°C to 40°C
Operating Humidity	0-95% RH, Non-Condensing
Operating Environment	Interior
Operation	APP
Ingress Protection (IP)	20

Product Package

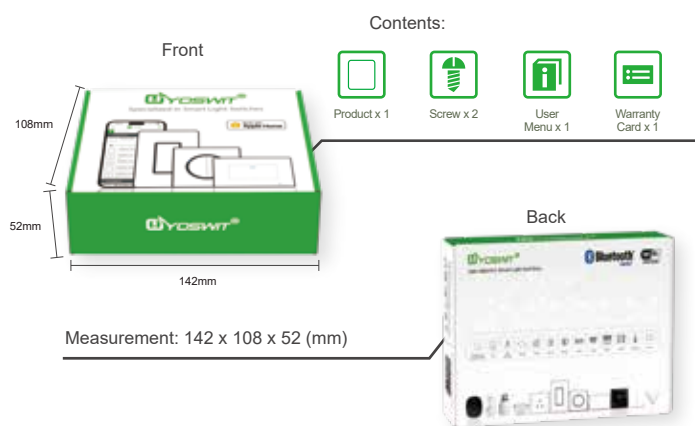

Outer Box



Product Warranty and Limitations

Yoswit brand products guarantee for a period of 2 years warranty from the date of purchase. During the warranty period and in the event that a defective product is identified (non-human factors), Yoswit will provide free maintenance. Damage beyond the warranty period or caused by improper use is not covered within the warranty, Yoswit will not bear any responsibility for repair, and will still provide users with a lifelong maintenance of paid services. If the products need to be repaired or returned to our company, an appropriate fee should be charged based on specific situation to cover the cost of replacement. Regardless of the warranty status, all shipping costs are borne by users.

LINCOGN TECHNOLOGY CO. LIMITED

Address: Room 202, 2/F, Building No. 19 West Science and Technology Avenue, Science Park, Shatin, N.T., Hong Kong
info@yoswit.com | Tel: (852) 3996 9396 | Fax: (852) 3119 8778 | www.yoswit.com